

Apply Wound Packing Gauze & Compress

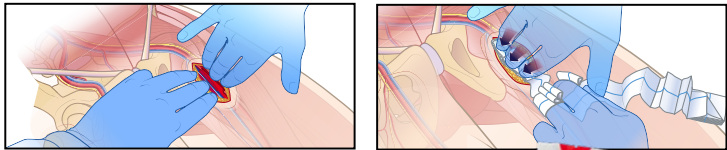

1. Find bleeding source and apply direct pressure.
2. Fill entire wound with gauze while maintaining constant pressure.
3. Hold pressure until first responders arrive.



Responder Emergency Trauma Dressing (ETD)

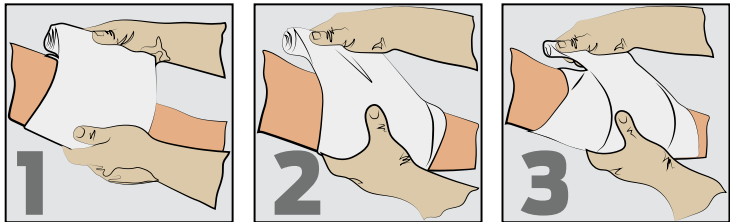

**Place Pad
over the
Wound**

**Wrap around
the Limb,
covering the
pad**

**Pull ETD Firmly,
and continue to
Wrap,** covering
the wound
completely

**Secure with
velcro
style fastener**
when wrap is
complete



Open Chest Wound

Apply HyFin® Chest Seal (*Intermediate & Advanced Kits*)

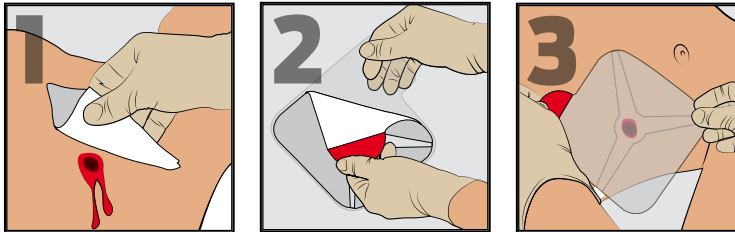

Wipe Wound with gauze

Peel Seal from Backing
using Red Tab

Center over wound

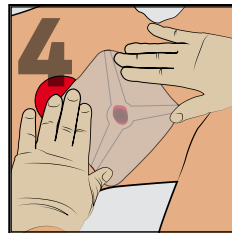

Firmly Press onto skin



Wrap Survival Blanket

1. Place the blanket over the patient
2. Tuck the edges in
3. Ensure that breathing is not inhibited

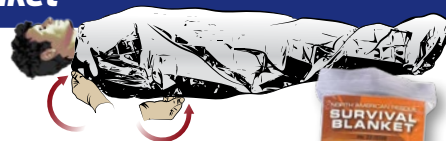

INSTRUCTIONS FOR USE

P U B L I C
A C C E S S

BLEEDING CONTROL



NORTH AMERICAN RESCUE®
www.NARescue.com • 888.689.6277

35 Tedwall Ct. • Greer SC 29650 • USA

Major Bleeding on Arm or Leg Apply C-A-T® Tourniquet



OR



OR

TWO-HANDED APPLICATION
Route the band around the limb, **pass the red tip through the slit of the buckle**, and position the C-A-T® 2-3" above the bleeding site directly to the skin.*

ONE-HANDED APPLICATION
Insert the injured limb through the loop in the band and position the C-A-T® 2-3" above the bleeding site directly to the skin.*

2



Pull band tightly and fasten it back on itself all the way around the limb, but not over the rod clips.

3

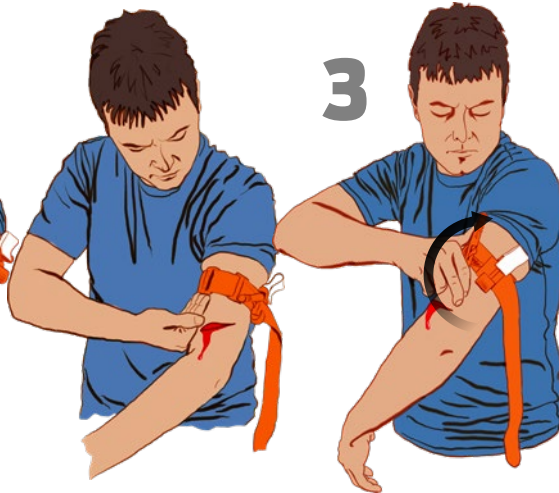

Band should be tight enough that **tips of three (3) fingers CANNOT be slid between the band and the limb**. If the tips of three (3) fingers slide under band, retighten and re-secure.

4



Secure the rod inside a clip to lock it in place. Check for bleeding and distal pulse. If bleeding is not controlled, or distal pulse is present, consider additional tightening or applying a second C-A-T® above and side-by-side to the first. Reassess.

5



Route the band between the clips and over the rod.
Secure rod and band with TIME strap. Record time of application.

*If you cannot be sure or cannot take the additional time to examine where the bleeding is coming from based on the situation, the C-A-T® can be effectively applied over clothing as high on the arm or leg as possible. The C-A-T® must NOT be applied over solid objects within the clothing. As soon as the situation permits, the injured limb should be evaluated and the C-A-T® re-positioned 2"-3" above the injury directly to the skin.